

Silver Springs Grand

Express Highway @ Keshampet



E.P.NO.: 12488/438/2019/e-panchayat

REF.No.: 438, OF LEMAMIDI G.P.,

T.L.P. No. 13 / 2020 /H



CAUTION:-
THIS LAYOUT IS LEGALLY VALID ONLY ON ITS RELEASE/APPROVAL BY THE CONCERNED GRAMPANCHAYAT UNDER SECTION 113(b) TELANGANA PANCHAYAT RAJ ACT 2015 (Act no 5 / 2015) AS COMMENCED WIDE G.O.Ms.No.22 PR & RD Dt:18-04-2018 AND UNDER RULE 11 (3)OF G.O.67 PR & RD, DT: 26-02-2002 ON FULLFILMENT OF ALL LAYOUT CONDITIONS. ANY TRANSACTIONS PRIOR TO THE ABOVE IS ILLEGAL.

LEMAMIDI G.P.

EXTRACT OF VILLAGE MAP

SITE UNDER REFERENCE :

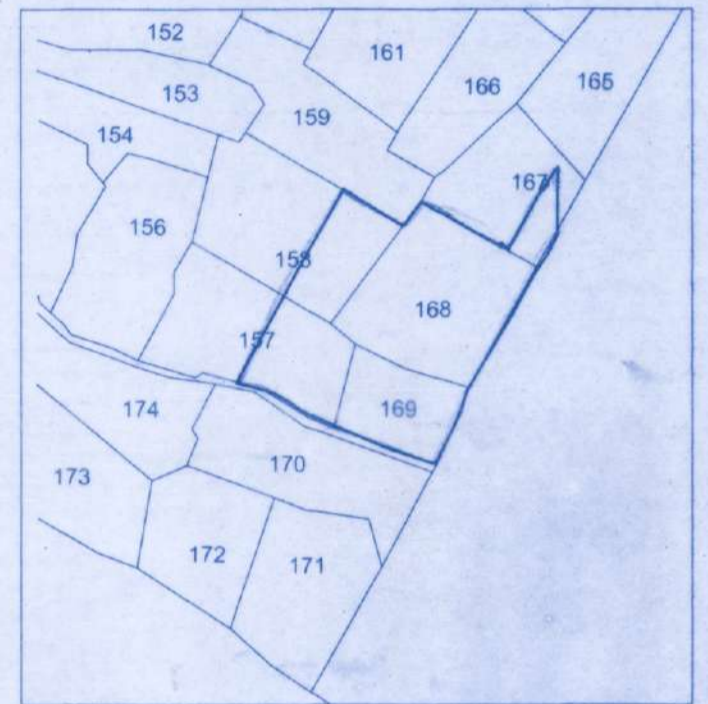

REFERENCE:

LAYOUT BOUNDARY
EXISTING ROADS
PROPOSED ROADS
MORTGAGE AREA

AREA STATEMENT:

LAYOUT AREA	AC 48.15 CENTS.	233046.00 SQ. YDS.
OPEN SPACE (10%)	AC 4.815 CENTS.	23304.60 SQ. YDS.
ROADS AREA (31.67%)	AC 15.250 CENTS.	73810.00 SQ. YDS.
PLOTTED AREA (58.33%)	AC 28.085 CENTS.	135931.40 SQ. YDS.
PRIMARY SCHOOL	AC 1.50 CENTS.	7260.00 SQ. YDS.
NURSERY SCHOOL	AC 0.25 CENTS.	1210.00 SQ. YDS.
CONVENIENT SHOPS (PLOT NO'S 515, 516, 530, 531, 546, 547, 563 AND 564)	AC 0.512 CENTS.	2478.08 SQ. YDS.
MORTGAGE AREA (15.26%) ON PLOTTED AREA (FROM PLOT NO. 1 to 94)	AC 4.287 CENTS.	20749.06 SQ. YDS.
NO. OF PLOTS	659	

NOTE:-

THE BUILDING PERMISSION FOR THE PLOT NO'S 1 TO 4, 25 TO 37, 469 TO 474 AND 502 TO 507 SHALL NOT BE GRANTED UNTIL AND UNLESS THE ELECTRICAL LINE IS SHIFTED ALONG THE PROPOSED ROADS.

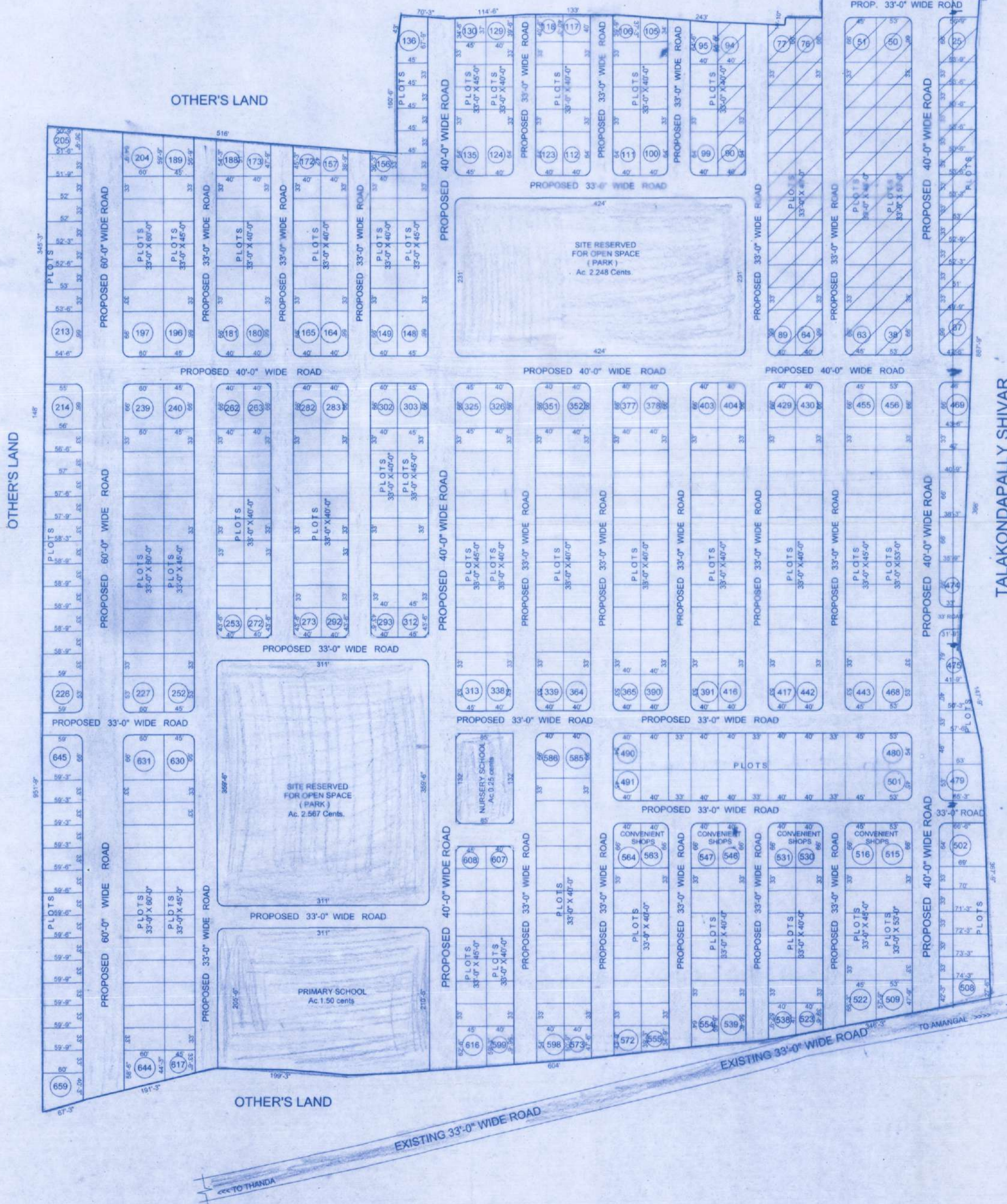

LEMAMIDI GRAM PANCHAYAT

DRAFT TECHNICAL LAYOUT PATTERN FOR RESIDENTIAL PLOTS IN SY.NO: 157/P,158/P,167/P,168,169 SITUATED AT LEMAMIDI VILLAGE KESHAMPET (M), RANGA REDDY DISTRICT

SCALE = 1" : 100'-0"

[Signature]
A.D.M.

[Signature]
20/11/2020
T.P.A.

[Signature]
21/11/2020
ASST. DIRECTOR

[Signature]
21.01.2020
DEPUTY DIRECTOR

[Signature]
21/1/2020
DIRECTOR OF TOWN & COUNTRY PLANNING
GOVT. OF TELANGANA, HYDERABAD.